

Adex Systems Inc.
Design No. ASI/WDEIFS 15-01
Exterior Wall Systems
Adex-RS Systems
CAN/ULC S101

Rating: 15 Minutes

**Meets the Requirements of Clause 3.2.3.8(1)(b) of the National Building Code of Canada,
2020, 2015, and 2010**

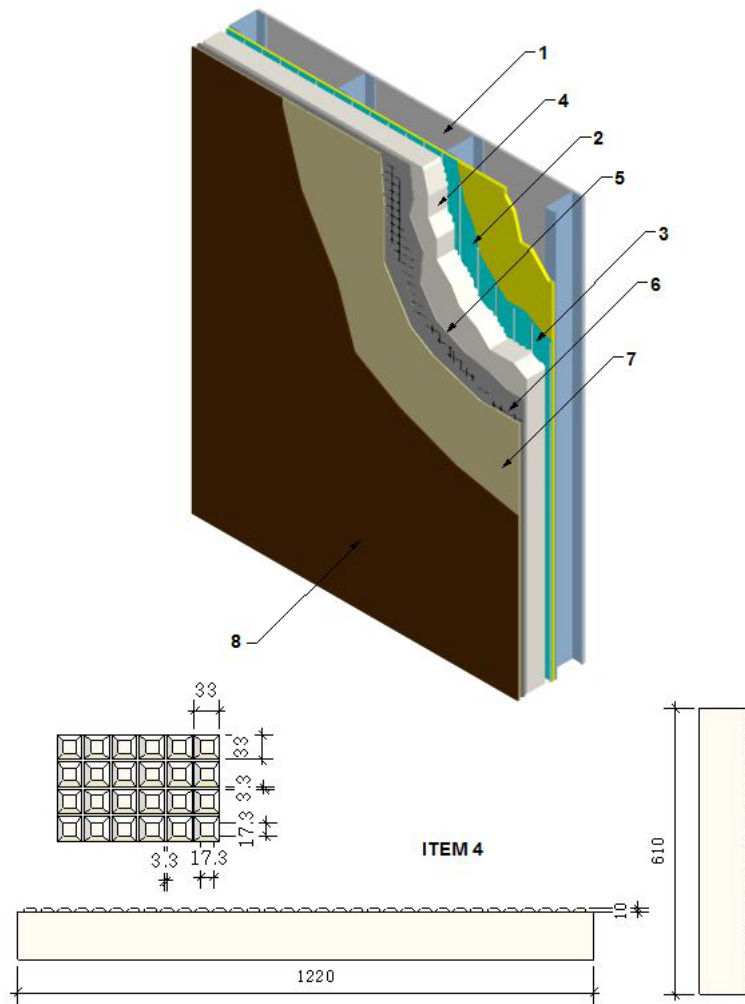

1. WALL ASSEMBLY: Construct a wall assembly that complies with the local Building Code or other applicable regulatory requirements when those are greater.

1A. JOINT TREATMENT: Treat the wall assembly (Item 1) exterior joints with Adex Uni-tape mesh or manufacturer approved 2 oz. min. mesh, applied along the sheathing joints.



2. CERTIFIED MANUFACTURER: Adex Systems Inc.

CERTIFIED PRODUCT: Water Resistive Barrier

CERTIFIED MODEL: Apply one of the following membranes in accordance with manufacturer's instructions to the exterior side of the wall assembly (Item 1):

- A. HYDROFLEX – STD acrylic-based air/moisture barrier mixed with Portland cement or,
- B. HYDROFLEX – VB ready to use rubber-based air/moisture/vapour barrier or,
- C. HYDROFLEX – WO ready to use rubber-based air/moisture barrier or,
- D. HYDROFLEX – AD ready to use air/moisture barrier.
- E. HYDROFLEX – A-Flex Seal ready to use rubber-based air/moisture barrier joint and opening treatment.

3. CERTIFIED MANUFACTURER: Adex Systems Inc.

CERTIFIED PRODUCT: Adex Adhesive/Basecoat

CERTIFIED MODEL: Apply one of the following adhesives:

- A. Adex Basecoat Adhesive is an acrylic polymer-based compound, mixed with Portland cement Type GU in a 1:1 ratio by weight.
- B. Adex Drymix Basecoat is one-component, acrylic polymer modified, cement-based powder.

Apply the Adex Adhesive as vertical ribbons onto the approved membrane on the wall using a 3/8 in. x 1/2 in. x 1-1/2 in. U-notched trowel and place the insulation boards horizontally.

- 4. INSULATION BOARD:** Use max. 5 in. (127mm) thick expanded polystyrene (EPS) GD insulation board manufactured under a quality assurance program and conforming to CAN/ULC S701 Type 1 (flame spread rating less than 500 as per CAN/ULC S102.2). The insulation board consists of chamfered grooves on the interior side of the board. Refer to diagram above.

5. CERTIFIED MANUFACTURER: Adex Systems Inc.

CERTIFIED PRODUCT: Adex Basecoat/Adhesive

CERTIFIED MODEL: Apply one of the following basecoats:

- A. Adex Basecoat Adhesive is an acrylic polymer-based compound, mixed with Portland cement Type GU in a 1:1 ratio by weight.
- B. Adex Drymix Basecoat is one-component, acrylic polymer modified, cement-based powder.

Apply the Adex Basecoat to the exterior side of the insulation board. Adex Basecoat is trowel-applied to the complete surface. A reinforcing mesh (Item 6) is embedded into the basecoat. Ensure that the mesh is completely embedded. The final thickness of the basecoat is min. 1.6mm (1/16 in.).

6. CERTIFIED MANUFACTURER: Adex Systems Inc.

CERTIFIED PRODUCT: Adex Standard Mesh

CERTIFIED MODEL: Reinforcing Mesh



Apply Adex Standard Mesh (min. 4.5 oz.) with the edges overlapped 64mm (2-1/2 in.) min. for EPS thicknesses up to 114.3mm (4-1/2 in.), or overlapped 101.6mm (4 in.) for EPS thicknesses above 114.3mm (4-1/2 in.), and completely embed into the basecoat (Item 5). Edges of insulation boards that meet dissimilar substrates, terminations, wall openings, etc., shall be back-wrapped, pre-wrapped, or edge-wrapped, according to manufacturer's specifications. For higher impact resistance, heavier mesh grades can be used (above 4.5 oz.) according to Adex Systems' specifications.

7. CERTIFIED MANUFACTURER: Adex Systems Inc.

CERTIFIED PRODUCT: Adex Primer (Optional)

CERTIFIED MODEL: Apply Adex Primex liquid coat as a priming agent for Adex finish coats.

8. CERTIFIED MANUFACTURER: Adex Systems Inc.

CERTIFIED PRODUCT: Adex Finish Coat

CERTIFIED MODEL: Trowel-apply the Adex Finish Coat over the dried-primer (Item 7) in accordance with Adex's installation guidelines for the specific finish.

9. PROTECTIVE COATING (Optional, Not Shown):

CERTIFIED MANUFACTURER: Adex Systems Inc.

CERTIFIED MODEL: Adex GraphexCoat A and Adex GraphexCoat B

Adex GraphexCoat is a two-part acrylic polymer-based compound, mixed with Portland cement.

Apply the Adex GraphexCoat A with a thickness of approximately 2.5mm (3/32 in.) over Adex Basecoat (Item 5) and the reinforcing mesh (Item 6). Once dry, apply Adex GraphexCoat B over Adex GraphexCoat A with a thickness of 1.6mm (1/16 in.). Once dry, Adex Primer (Item 7) and Adex Finish Coat (Item 8) can then be applied.

10. ADDITIONAL COMPONENTS:

- A. PVC STARTER TRACKS – Starter drainage strips installed horizontally.
- B. MECHANICAL FASTENERS – According to the manufacturer's specifications.

Consult the listing report on the Directory of Building Products (<https://bpdirectory.intertek.com>) for the edition of the standard(s) evaluated.

Compliance of the assembly described in this Design Listing with the referenced standard relies on verification that the assembly constructed in the field is consistent with that described herein. Intertek certified products may be verified by the approved Intertek label; other products must be verified by the Authority Having Jurisdiction as meeting the specifications stated herein.